

SEC 18, TWP. 45 S., RGE 43 E.

Approved By  
 PALM BEACH COUNTY  
 HEALTH DEPT.  
 Date: 4/6/70 No. 011P  
 Sanitarian  
 Not intended to cover  
 Structural Design  
 Subject to Approval of  
 Hotel & Restaurant Comm.  
 City Building & Zoning Dept.  
 County Building & Zoning Dept.

TOM S. M.W.  
 Sand & Sea N.

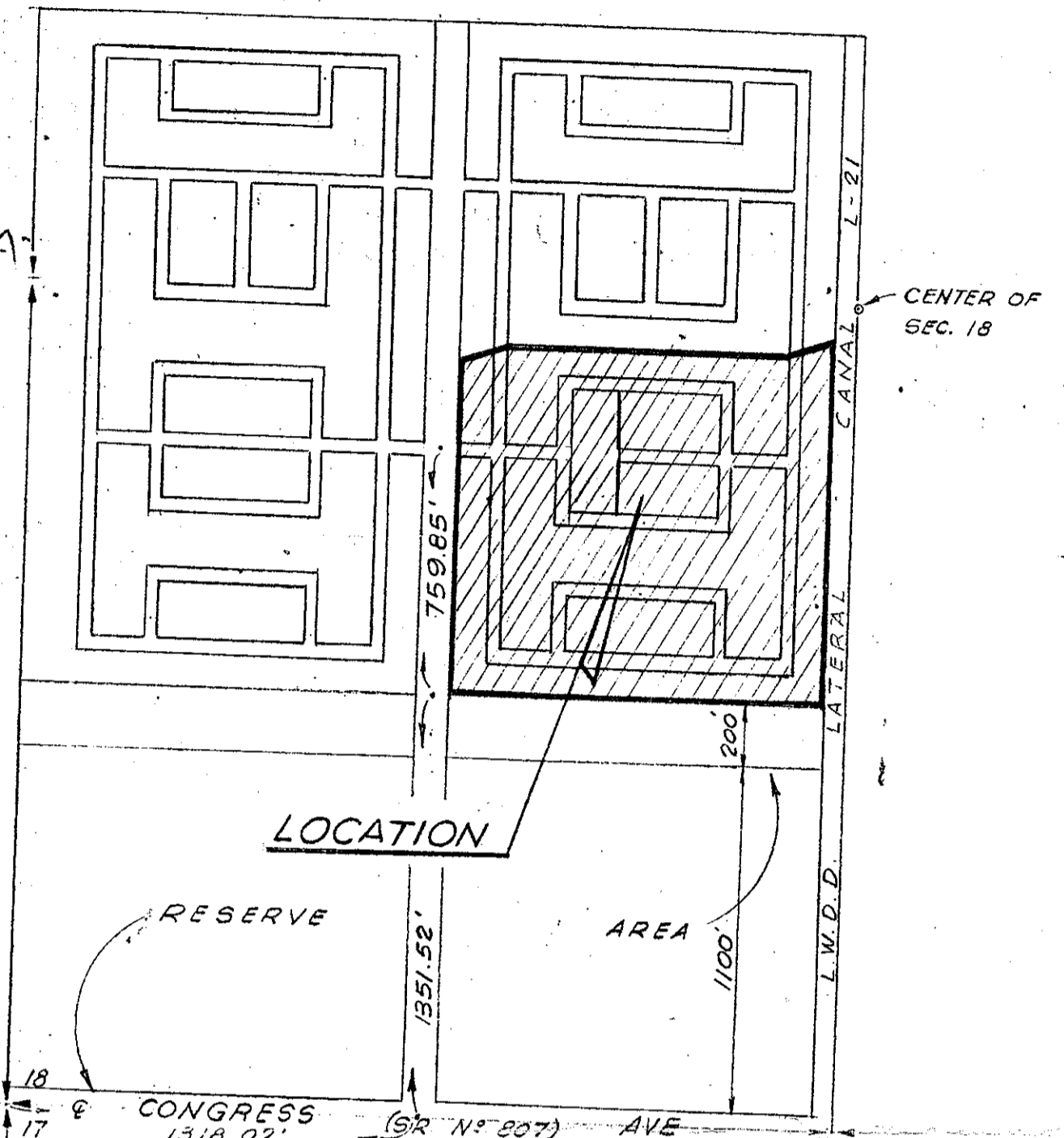

CURVE DATA

- "A" Δ = 87° 22' 19" R = 45.00' T = 42.98' Arc = 68.62'
- "B" Δ = 92° 37' 41" R = 45.00' T = 47.11' Arc = 72.75'
- "C" Δ = 92° 42' 59" R = 45.00' T = 47.19' Arc = 72.82'
- "D" Δ = 87° 17' 01" R = 45.00' T = 42.92' Arc = 68.55'

mh0037.igr  
 SAND AND SEA MHP

NOTE: DELETED LOTS 147, 158, 159 AND 170

195 LOTS

BENCH MARKS

- № 1 - DISC IN N.E. WINGWALL OF BOX CULVERT @ CONGRESS AVE. & L.W.D.D. LAT. № 22 ELEV. = 13.23
- № 2 - TOP BOX CULVERT @ CONGRESS AVE. & L.W.D.D. LAT. № 21 ELEV. = 13.10

PHASE I

MOCK, ROOS & SEARCY, INC.  
 FORMERLY

**K. C. MOCK & ASSOCIATES, INC.**  
 CONSULTING ENGINEERS  
 WEST PALM BEACH

PROPOSED LAYOUT  
 FOR SAND & SEA VILLAGE  
 MOBILE HOME COMMUNITY  
 PALM BEACH COUNTY, FLORIDA

3 APR 70 JBC REV 1	WIDTH OF 34TH AVE SO & 34TH DR SO TO 30'	DATE	BY	DESCRIPTION	REF. PLAT	SCALE	DATE	DWG. NO.
26 FEB 69 JBC				GENERAL REVISION	FIELD: 54	1" = 60'	MAY 1969	45-23-19-5
6 MAY 69 JBC DE	ED LOTS 147, 158, 159 & 170			REVISIONS	CHECK: E.J.R			
					DR. BY: D.S.-J.B.C.		69-38	SHEET 2 of 5

DRAWN BY: JAMES H. HAYES  
 CHECKED BY: JAMES H. HAYES  
 DATE: 4-1-86  
 APP. & SEAL: [Signature]